

Specification	3kV-100A 1 Pin with ICF70 Flange
Model No.	PF-CM6-3kV-100A-I70-1
Contact	osaka-sales@kawaso-texcel.co.jp Koeln-sales@kawaso-texcel.de (in Europe)
Kawaso Texcel CO., Ltd.	

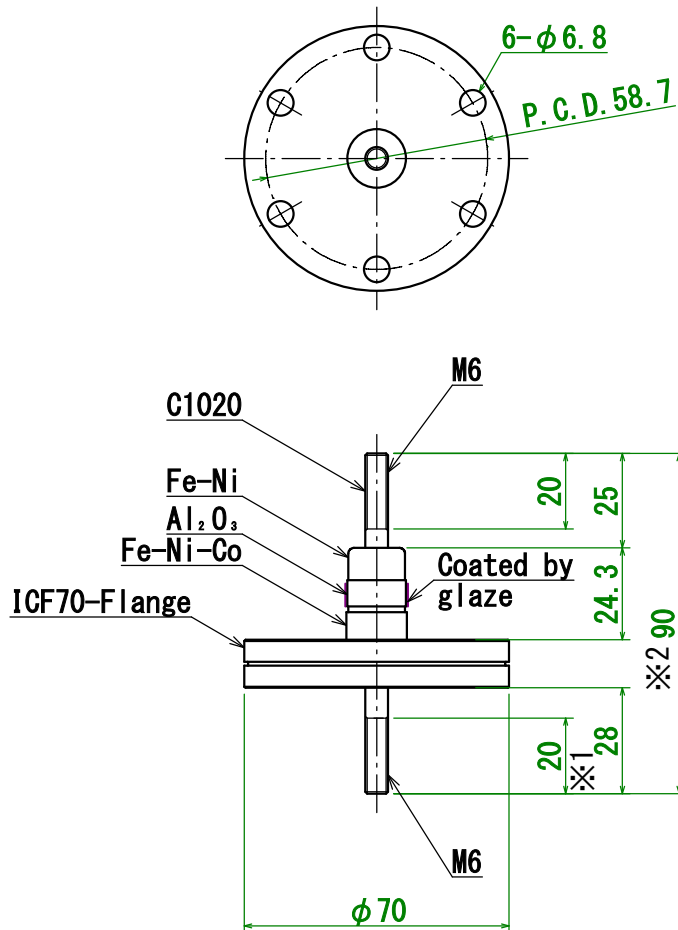

Model No. : PF-CM6-3kV-100A-I70-1

Available L type which is extending electrode of Vacuum side.
 (※ Dimension 1 :63 mm ※ Dimension 2 :125mm)
 Model No :PF-CM6-3kV-100A-L-ICF70-1

Caution : If you use crimp terminal and SUS nuts for the connection to the electrode of feedthrough, SUS nuts may become HIGH Temperature

Dimensions are in Millimeter.